

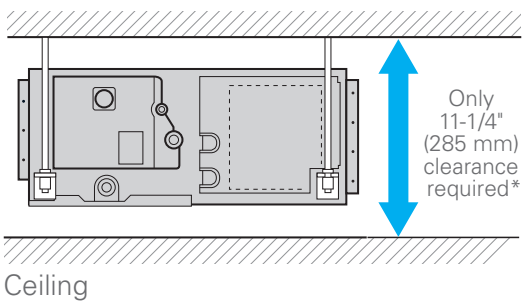

## Slender. Powerful. Comfortable.

Engineered with impressive static pressure capabilities in a compact, flexible chassis design.



### Do More with Less.

Daikin's FXSQ\_TAVJU MSP Concealed Ducted unit gives designers a tool to approach even the most cramped air conditioning applications. A high efficiency DC fan motor delivers nominal CFM up to 0.6" external static pressure, all from a compact chassis design measuring a mere 9-11/16" (245 mm) high. A selectable Auto\*\* fan speed control automatically adjusts the fan speed in response to the room temperature for better felt comfort and reduced fan energy use.

\* Refer to installation manual for all installation clearance requirements.

\*\* Auto fan speed requires the use of the BRC1E73 controller

The "Daikin" and "VRV" trademarks are owned by Daikin Industries, Ltd. and Registered in the U.S. Patent and Trademark Office.

Capacity Range: 0.5 to 4.5 tons

### Applications



### Features

- » Powerful static pressure capability, with up to 0.6 in.w.g. (150Pa) external static pressure.
- » Ease of installation with auto adjusting airflow at commissioning based on external static pressure.
- » Designed for installation flexibility, with a factory rear-return configuration and field convertible to bottom return.
- » Sound levels as low as 28 dB(A) for quiet operation.
- » Provides a high degree of control for auxiliary heating devices, with independently configurable on/off temperature values.
- » Integral condensate pump with up to 25-5/16" (643mm) of lift from the drain outlet.



\* Complete warranty details available from your local dealer or at [www.daikincomfort.com](http://www.daikincomfort.com).

SPECIFICATIONS			0.5 TON	0.6 TON	0.75 TON	1.0 TON	1.25 TON	1.5 TON
Model Name			FXSQ05TAVJU	FXSQ07TAVJU	FXSQ09TAVJU	FXSQ12TAVJU	FXSQ15TAVJU	FXSQ18TAVJU
Capacity Index			5.8	7.5	9.5	12	15	18
Power Supply			V/ph/Hz 208/230VAC, 60Hz, 1 phase					
Nominal Cooling Capacity*1			Btu/h (kW) 5,800 (1.7)	7,500 (2.2)	9,500 (2.8)	12,000 (3.6)	15,000 (4.5)	18,000 (5.6)
Nominal Heating Capacity*2			Btu/h (kW) 6,500 (1.9)	8,500 (2.5)	10,500 (3.1)	13,500 (4.0)	16,500 (5.6)	20,000 (6.3)
Fan	Type	Sirocco fan						
	Motor Output	W	78				130	230
	Air Flow Rate (H/M/L)	CFM	281 / 265 / 230		318 / 265 / 230	335 / 283 / 247	530 / 441 / 371	600 / 512 / 406
	Drive Type	DC Direct Drive						
	External Static Pressure (Std./Max)	0.2 / 0.6					0.4 / 0.6	
Height	in. (mm)	9-11/16						
Width	in. (mm)	21-11/16				27-9/16		39-3/8
Depth	in. (mm)	31-1/2						
Weight (net)	lb. (kg)	55 (25)					60 (27)	77 (35)
Condensate Pump Lift	in. (mm)	25-5/16 (643)						
Sound Pressure Level (H/M/L speed)	dB(A)	33 / 30 / 28			34 / 32 / 30		36 / 33 / 30	34 / 32 / 29
Pipe Connections	Liquid	in.	1/4 (Flare)					
	Gas	in.	1/2 (Flare)					
	Condensate Drain	in.	VP25					
Refrigerant Control	Electronic Expansion Valve							
Maximum Overcurrent Protection Device	A	15						
Minimum Circuit Ampacity	A	0.8					1.4	1.6

SPECIFICATIONS			2.0 TON	2.5 TON	3.0 TON	4.0 TON	4.5 TON		
Model Name			FXSQ24TAVJU	FXSQ30TAVJU	FXSQ36TAVJU	FXSQ48TAVJU	FXSQ54TAVJU		
Capacity Index			24	30	36	48	54		
Power Supply			V/ph/Hz 208/230VAC, 60Hz, 1 phase						
Nominal Cooling Capacity*1			Btu/h (kW) 24,000 (7.1)	30,000 (9.0)	36,000 (11.2)	48,000 (14.0)	54,000 (15.8)		
Nominal Heating Capacity*2			Btu/h (kW) 27,000 (8.0)	34,000 (10.0)	40,000 (11.7)	54,000 (16.0)	60,000 (17.6)		
Fan	Type	Sirocco fan							
	Motor Output	W	230			300		350	
	Air Flow Rate (H/M/L)	CFM	742 / 618 / 512		812 / 689 / 565	1130 / 953 / 795	1307 / 1112 / 918	1377 / 1183 / 989	
	Drive Type	DC Direct Drive							
	External Static Pressure (Std./Max)	0.4 / 0.6					0.4 / 0.56		
Height	in. (mm)	9-11/16							
Width	in. (mm)	39-3/8			55-1/8		61		
Depth	in. (mm)	31-1/2							
Weight (net)	lb. (kg)	82 (37)			101 (46)		104 (47)	115 (52)	
Condensate Pump Lift	in. (mm)	25-5/16 (643 mm)							
Sound Pressure Level (H/M/L speed)	dB(A)	36 / 32 / 29		37.5 / 34 / 30		39 / 35 / 32		42 / 38.5 / 35	43 / 40 / 36
Pipe Connections	Liquid	in.	3/8 (Flare)						
	Gas	in.	5/8 (Flare)						
	Condensate Drain	in.	VP25						
Refrigerant Control	Electronic Expansion Valve								
Maximum Overcurrent Protection Device	A	15							
Minimum Circuit Ampacity	A	1.8			2.5		2.8	3.3	

Note:

\*1. Nominal cooling capacities are based on the following conditions: 80 °FDB / 67 °FWB (26.7 °CDB / 19.4 °CWB) return air temperature; 95 °FDB (35 °CDB) outdoor temperature; 25 ft. (7.6 m) equivalent refrigerant piping.

\*2. Nominal heating capacities are based on the following conditions: 70 °FDB (21.1 °CDB) return air temperature; 47 °FDB / 43 °FWB (8.3 °CDB / 6.1 °CWB) outdoor temperature; 25 ft. (7.6 m) equivalent refrigerant piping.

## Standard Features:

### Auto Fan Speed Control



To reduce operating sound and power consumption, the fan speed is automatically controlled by the micro-processor to suit the controller setting and prevailing room temperature.

### Drain Pan Inspection Port



A maintenance-friendly drain pan inspection port makes it quick and easy to check the conditions of the drain pan. The drain pan can be easily removed for cleaning.

### Integral Condensate Pump



A built-in condensate pump with more than 25" (635 mm) of lift eliminates the cost and labor associated with installing external condensate pumps.

## Flexible Installation.

The FXSQ\_TA can easily be converted to a bottom-return configuration to optimize the use of space above the ceiling or bulkhead space.

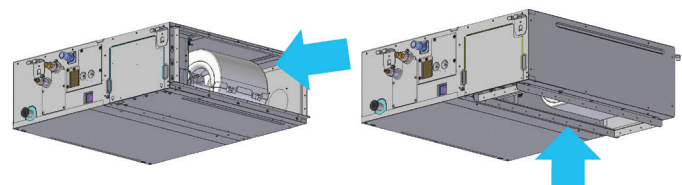

## ADDITIONAL INFORMATION

Before purchasing this appliance, read important information about its estimated annual energy consumption, yearly operating cost, or energy efficiency rating that is available from your retailer.

Visit [www.daikincomfort.com](http://www.daikincomfort.com)



Our continuing commitment to quality products may mean a change in specifications without notice.

© 2018 **DAIKIN NORTH AMERICA LLC** · Houston, Texas · USA · [www.daikincomfort.com](http://www.daikincomfort.com) or [www.daikinac.com](http://www.daikinac.com)

PF-FXSQ-TAVJU 1-18